

VISTA LATERAL

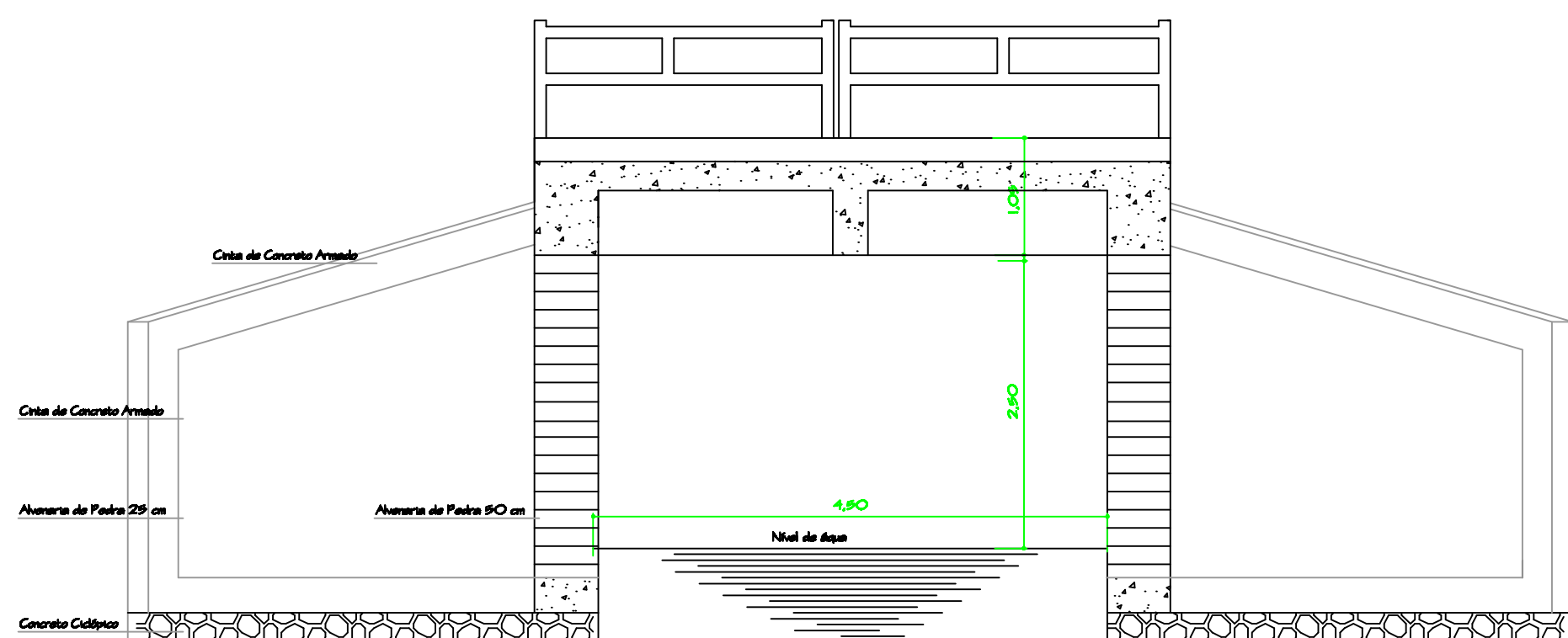

CORTE LATERAL

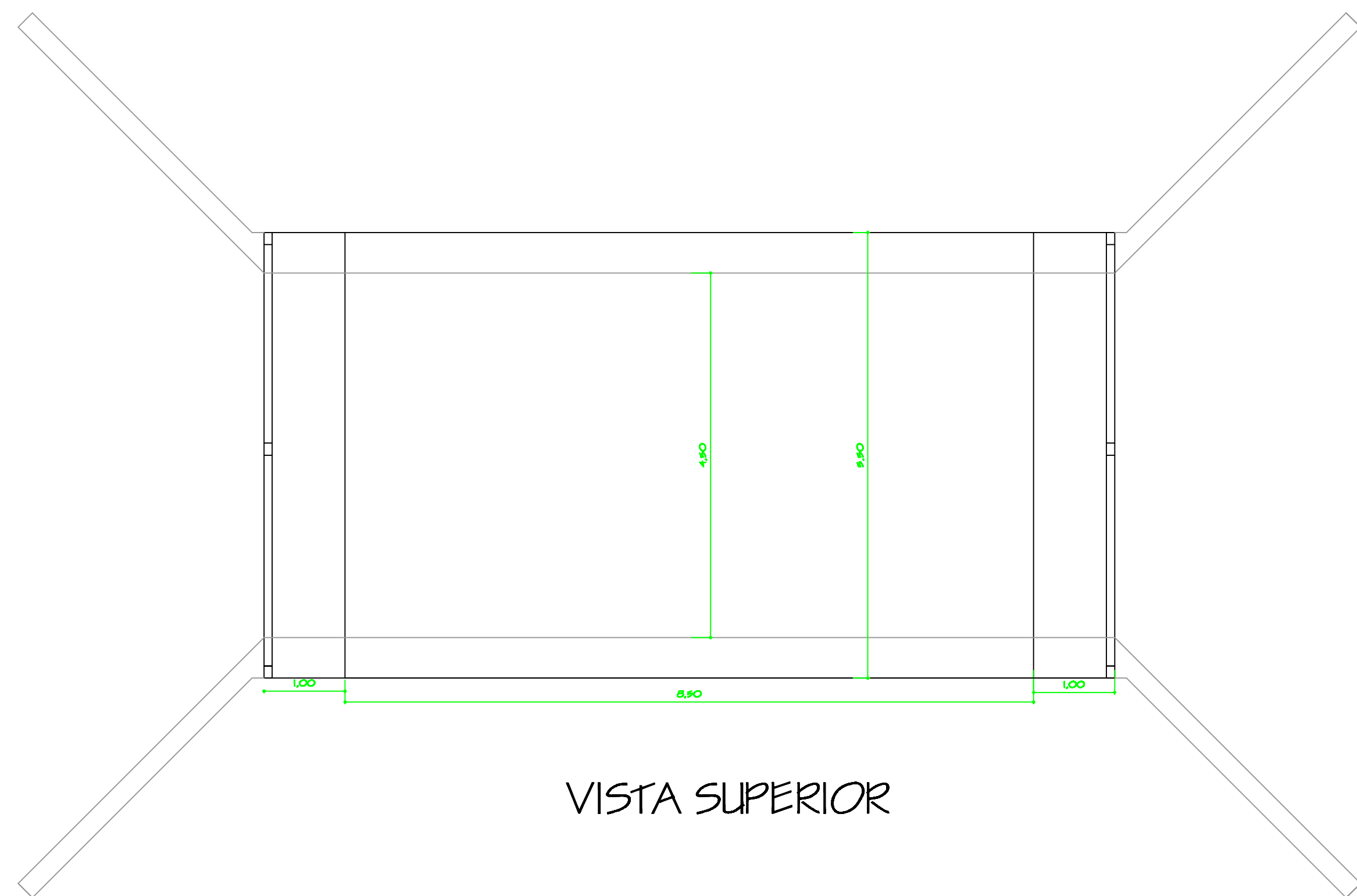

VISTA SUPERIOR

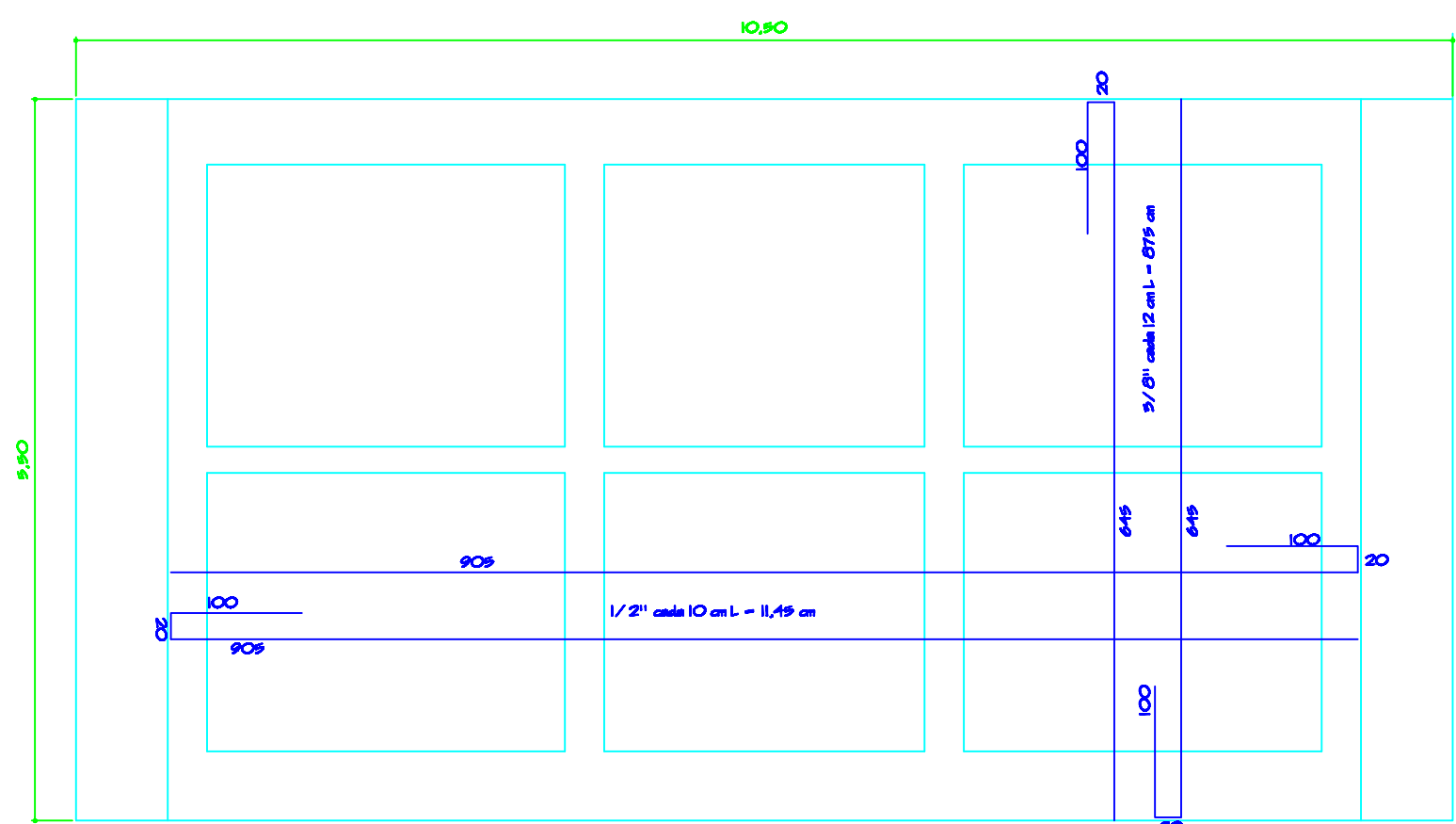

ESTRUTURAL LAJE

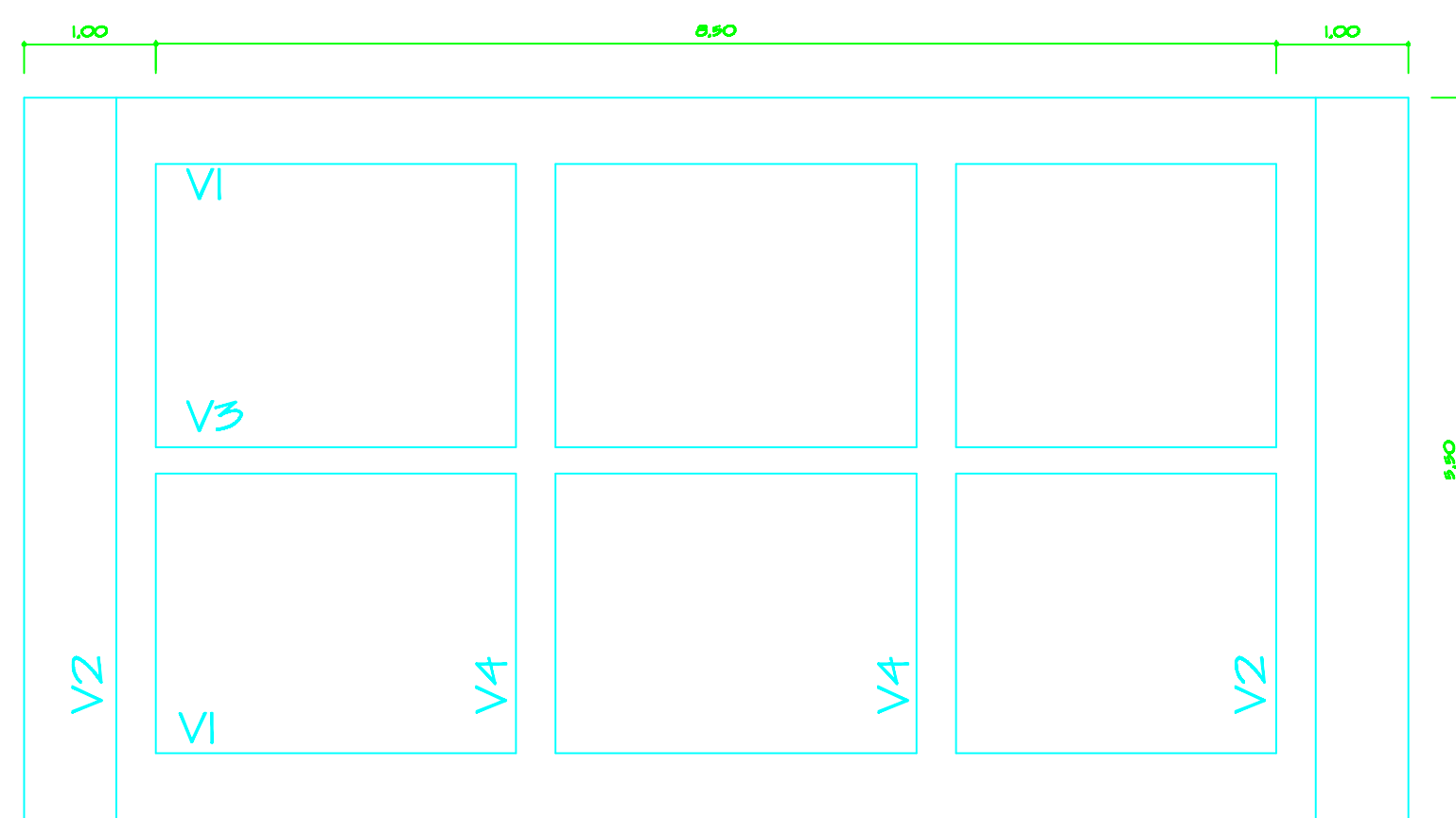

ESTRUTURAL (Forma)

RESUMO CONCRETOS E SERVIÇOS		
DISCRICÃO	QUANTIDADE	UNIDADE
Concreto Cidrápio	8,55	M3
Cintas	5,88	M5
Viagem Concreto Armado	17,88	M5
Laje de Concreto Armado	14,44	M5
Alvenaria de pedra 25 cm	39,00	M2
Alvenaria de Pedra 50 cm	52,90	M2
Guarda Corpo ConcretoPré-moldado	11,00	NL

COORDENADAS GEOGRÁFICAS	
S 28° 34' 17.19"	WO 51° 52' 38.23"

V1 (85x30 CM)

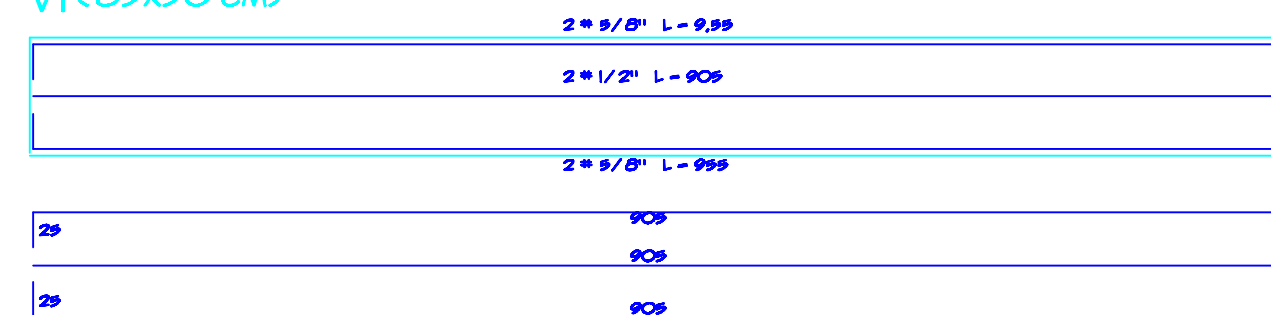

2 x V2 (105x30 CM)

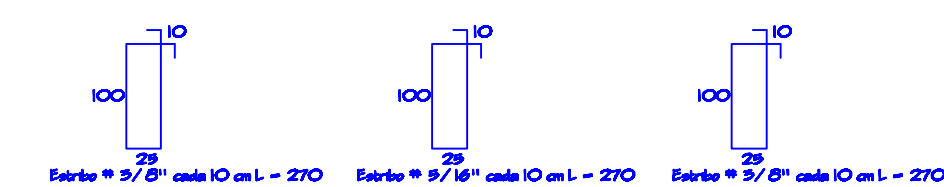
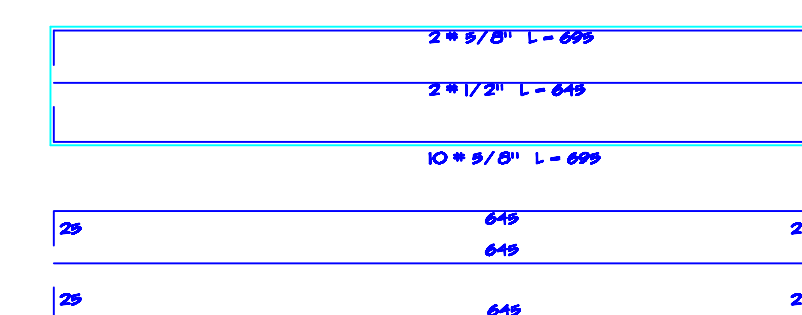

2 x V4 (80x30 CM)

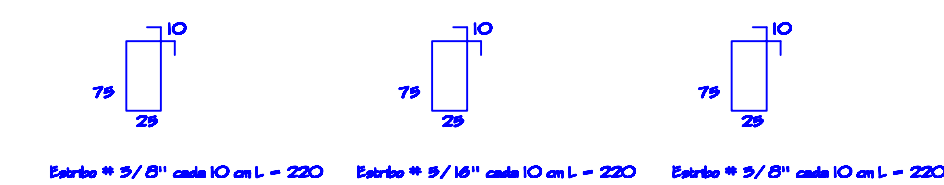
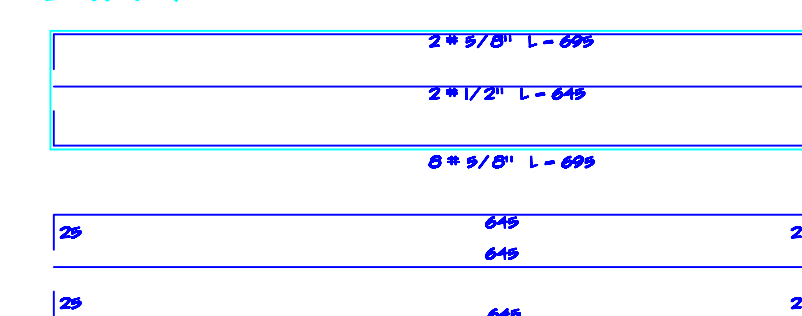

V3 (85x30 CM)

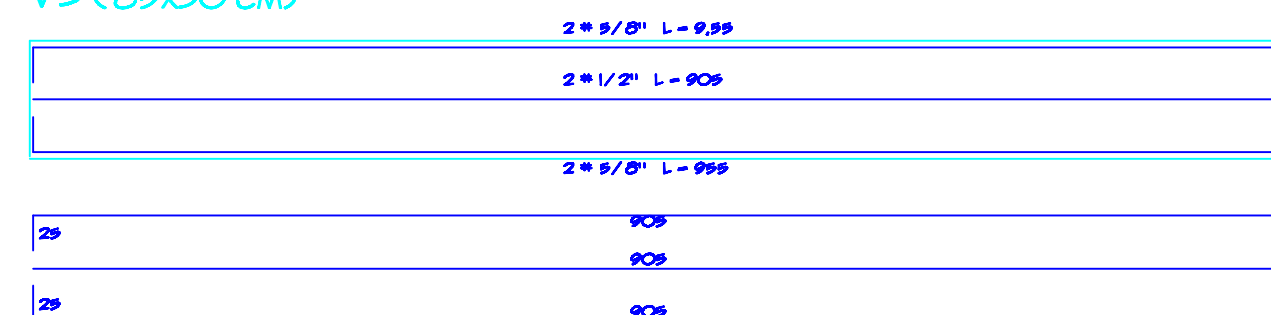

Decol Engenharia Ltda.

Obra: PONTE DE CONCRETO SITUADO SOBRE O ARROIO FITA VERDE – COM. SÃO VALENTIN – SÃO DOMINGOS DO SUL – RS

Resp. Técnico
Eng.º Civil – 020008-0
CREA 63611

Proprietário
P. M. SÃO DOMINGOS DO SUL

Descrição: PONTE DE CONCRETO

Escala: 1 : 50

Desenho: Ladr Decol

Estimado: 4,50 m

Data: Dez/ 2014

Próximo